

M3 Junction 9 Improvement

Scheme Number: TR010055

2.4 Rights of Way and Access Plans (Rev 1)

APFP Regulations 5(2)(k)

Planning Act 2008

**Infrastructure Planning (Applications: Prescribed Forms and
Procedure) Regulations 2009**

Volume 2

15 June 2023



NOTES
 Purpose of use
APPLICATION SUBMISSION
 Development Consent Order Number / Document
 TR010055/2.4

1. THIS DRAWING HAS BEEN PRODUCED USING CAD SOFTWARE. THEREFORE ALL DIMENSIONS ARE SHOWN IN METRES UNLESS SHOWN OTHERWISE.
 2. DO NOT SCALE FROM THIS DRAWING. USE ONLY PRINTED DIMENSIONS.

KEY TO SYMBOLS
 — DEVELOPMENT CONSENT ORDER BOUNDARY

REV	DATE	REVISION NOTE	ORIG	CHKD	APPD
0	NOVEMBER 2022	APPLICATION SUBMISSION	GP	LC	MF

DESIGNER

CONTRACTOR

CLIENT

PROJECT TITLE
 M3 JUNCTION 9 IMPROVEMENT SCHEME

PROJECT STAGE
 PCF STAGE 3

DRAWING TITLE
 RIGHTS OF WAY & ACCESS PLANS
 APFP REGULATION S(2)(K)
 KEY PLAN
 DOCUMENT REFERENCE: 2.4

SUITABILITY
 APPLICATION SUBMISSION
 SHEET SIZE: A1 SCALE: 1:12500 STATUS: REV 0
 DRAWING NUMBER
 HES51511-VFK-LSI-X_XXXX_XX-DR-ZL-2000

© Crown copyright and database rights 2022. Use of this data is subject to terms and conditions. Ordnance Survey Licence 100030649.

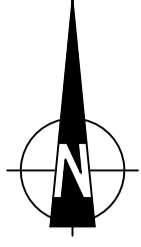

BASINGSTOKE

M3

PRIVATE FARM TRACK

PRIVATE FARM TRACK

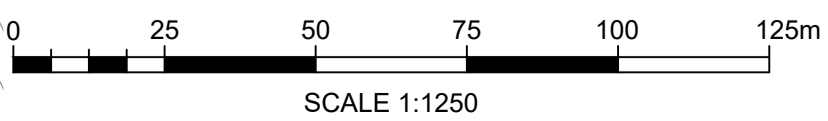

NOTES

Purpose of use
APPLICATION SUBMISSION

Development Consent Order Number / Document
TR010055/2.4

- THIS DRAWING HAS BEEN PRODUCED USING CAD SOFTWARE. THEREFORE ALL DIMENSIONS ARE SHOWN IN METRES UNLESS SHOWN OTHERWISE.
- DO NOT SCALE FROM THIS DRAWING. USE ONLY PRINTED DIMENSIONS.
- PROPOSED EARTHWORK EMBANKMENTS / CUTTINGS HAVE BEEN OMITTED FOR CLARITY.
- THE DESIGN SHOWN WILL BE SUBJECT TO DETAILED DESIGN DEVELOPMENT IN ACCORDANCE WITH THE PROVISIONS OF THE DEVELOPMENT CONSENT ORDER.

KEY TO SYMBOLS

- DEVELOPMENT CONSENT ORDER BOUNDARY
- LAND NOT INCLUDED IN ORDER LIMITS
- PROPOSED ROAD MARKINGS
- EXISTING HIGHWAY TO BE STOPPED UP
- EXISTING PRIVATE MEANS OF ACCESS TO BE STOPPED UP
- NEW, ALTERED OR IMPROVED HIGHWAY - SPECIAL ROAD
- NEW, ALTERED OR IMPROVED HIGHWAY - TRUNK ROAD
- NEW, ALTERED OR IMPROVED HIGHWAY - CLASSIFIED ROAD
- NEW, ALTERED OR IMPROVED PRIVATE MEANS OF ACCESS
- - - EXISTING PUBLIC RIGHT OF WAY
- - - EXISTING FOOTWAY / FOOTPATH
- - - EXISTING CYCLEWAY
- x x x EXISTING PUBLIC RIGHT OF WAY TO BE PERMANENTLY STOPPED UP
- x x x EXISTING FOOTWAY / FOOTPATH TO BE PERMANENTLY STOPPED UP
- x x x EXISTING CYCLEWAY TO BE PERMANENTLY STOPPED UP
- NEW, ALTERED OR IMPROVED FOOTPATH / CYCLE PATH ROUTE
- NEW, ALTERED OR IMPROVED FOOTPATH LINK TO EXISTING PUBLIC RIGHT OF WAY
- NEW, ALTERED OR IMPROVED PUBLIC RIGHT OF WAY
- PROPOSED STRUCTURE
- START / END POINT AS DETAILED IN SCHEDULE 3 AND 4 OF THE DEVELOPMENT CONSENT ORDER
- F/C 1 FOOTWAY / CYCLEWAY REFERENCE AS DETAILED IN SCHEDULE 4 OF THE DEVELOPMENT CONSENT ORDER
- A PRIVATE MEANS OF ACCESS REFERENCE AS DETAILED IN SCHEDULE 3 AND 4 OF THE DEVELOPMENT CONSENT ORDER
- PROPOSED SURFACE WATER ATTENUATION BASIN MAINTENANCE ACCESS / TRACK
- PROPOSED REALIGNED ROUTE OF NCN 23

01	JUNE 2023	DEADLINE 2	EO	LC	MF
0	NOVEMBER 2022	APPLICATION SUBMISSION	GP	LC	MF
REV	DATE	REVISION NOTE	ORIG	CHKD	APPD

REFERENCE MAP

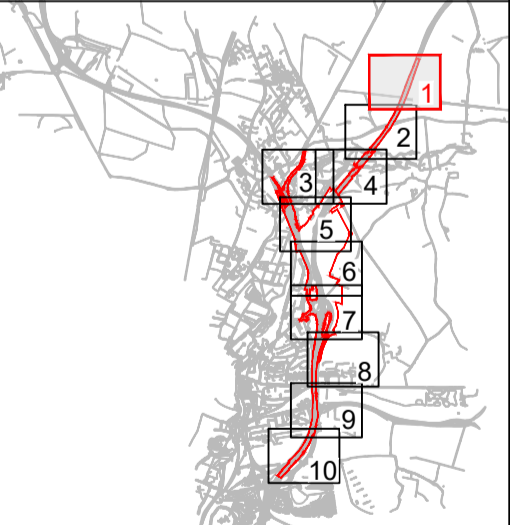

DESIGNER

CONTRACTOR

CLIENT

PROJECT TITLE
M3 JUNCTION 9 IMPROVEMENT SCHEME

PROJECT STAGE
PCF STAGE 3

DRAWING TITLE
RIGHTS OF WAY & ACCESS PLANS
APFP REGULATION S(2)(K)
SHEET 1 OF 10
DOCUMENT REFERENCE: 2.4

SUITABILITY
APPLICATION SUBMISSION

SHEET SIZE: A1 SCALE: 1:1250 STATUS: REV 01
DRAWING NUMBER
HES51511-VFK-LSI-X_XXXX_XX-DR-ZL-2001

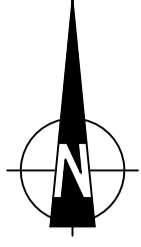

ABBOTS WORTHY

B3047

M3

B3047

B3047

RIVER ITCHEN

RIVER ITCHEN



SCALE 1:1250

NOTES

Purpose of use
APPLICATION SUBMISSION
 Development Consent Order Number / Document
TR010055/2.4

- THIS DRAWING HAS BEEN PRODUCED USING CAD SOFTWARE. THEREFORE ALL DIMENSIONS ARE SHOWN IN METRES UNLESS SHOWN OTHERWISE.
- DO NOT SCALE FROM THIS DRAWING. USE ONLY PRINTED DIMENSIONS.
- PROPOSED EARTHWORK EMBANKMENTS / CUTTINGS HAVE BEEN OMITTED FOR CLARITY.
- THE DESIGN SHOWN WILL BE SUBJECT TO DETAILED DESIGN DEVELOPMENT IN ACCORDANCE WITH THE PROVISIONS OF THE DEVELOPMENT CONSENT ORDER.

KEY TO SYMBOLS

- DEVELOPMENT CONSENT ORDER BOUNDARY
- LAND NOT INCLUDED IN ORDER LIMITS
- PROPOSED ROAD MARKINGS
- EXISTING HIGHWAY TO BE STOPPED UP
- EXISTING PRIVATE MEANS OF ACCESS TO BE STOPPED UP
- NEW, ALTERED OR IMPROVED HIGHWAY - SPECIAL ROAD
- NEW, ALTERED OR IMPROVED HIGHWAY - TRUNK ROAD
- NEW, ALTERED OR IMPROVED HIGHWAY - CLASSIFIED ROAD
- NEW, ALTERED OR IMPROVED PRIVATE MEANS OF ACCESS
- EXISTING PUBLIC RIGHT OF WAY
- EXISTING FOOTWAY / FOOTPATH
- EXISTING CYCLEWAY
- x x x EXISTING PUBLIC RIGHT OF WAY TO BE PERMANENTLY STOPPED UP
- x x x EXISTING FOOTWAY / FOOTPATH TO BE PERMANENTLY STOPPED UP
- x x x EXISTING CYCLEWAY TO BE PERMANENTLY STOPPED UP
- NEW, ALTERED OR IMPROVED FOOTPATH / CYCLE PATH ROUTE
- NEW, ALTERED OR IMPROVED FOOTPATH LINK TO EXISTING PUBLIC RIGHT OF WAY
- NEW, ALTERED OR IMPROVED PUBLIC RIGHT OF WAY
- PROPOSED STRUCTURE
- 1 START / END POINT AS DETAILED IN SCHEDULE 3 AND 4 OF THE DEVELOPMENT CONSENT ORDER
- F/C 1 FOOTWAY / CYCLEWAY REFERENCE AS DETAILED IN SCHEDULE 4 OF THE DEVELOPMENT CONSENT ORDER
- A PRIVATE MEANS OF ACCESS REFERENCE AS DETAILED IN SCHEDULE 3 AND 4 OF THE DEVELOPMENT CONSENT ORDER
- PROPOSED SURFACE WATER ATTENUATION BASIN MAINTENANCE ACCESS / TRACK
- PROPOSED REALIGNED ROUTE OF NCN 23

01	JUNE 2023	DEADLINE 2	EO	LC	MF
0	NOVEMBER 2022	APPLICATION SUBMISSION	GP	LC	MF
REV	DATE	REVISION NOTE	ORIG	CHKD	APPD

REFERENCE MAP

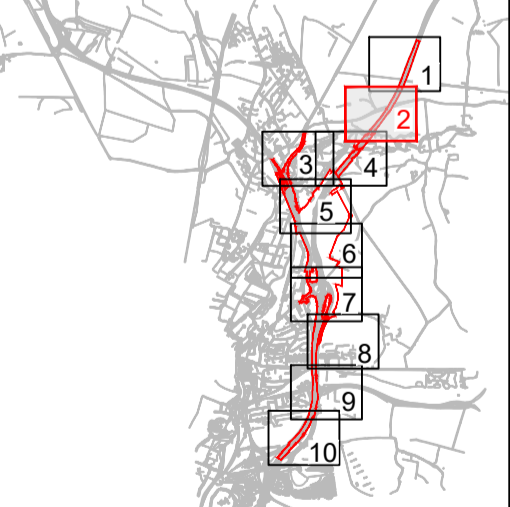

DESIGNER

CONTRACTOR

CLIENT

PROJECT TITLE
M3 JUNCTION 9 IMPROVEMENT SCHEME

PROJECT STAGE
PCF STAGE 3

DRAWING TITLE
RIGHTS OF WAY & ACCESS PLANS
APFP REGULATION S(2)(K)
SHEET 2 OF 10
DOCUMENT REFERENCE: 2.4

SUITABILITY
APPLICATION SUBMISSION

SHEET SIZE: A1 SCALE: 1:1250 STATUS: REV 01
DRAWING NUMBER
HES51511-VFK-LSI-X_XXXX_XX-DR-ZL-2002

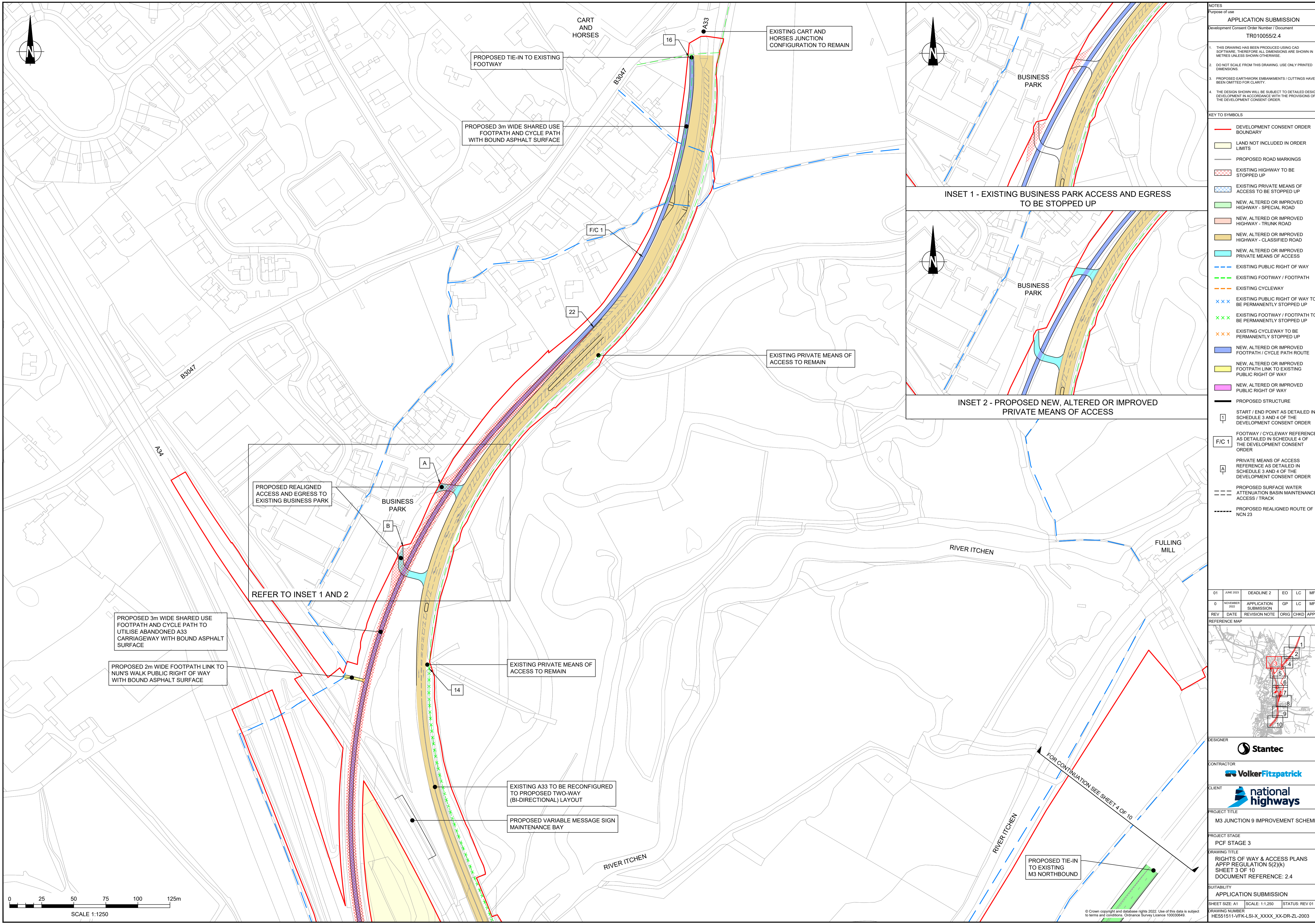

NOTES

Purpose of use
APPLICATION SUBMISSION
 Development Consent Order Number / Document
 TR010055/2.4

- THIS DRAWING HAS BEEN PRODUCED USING CAD SOFTWARE. THEREFORE ALL DIMENSIONS ARE SHOWN IN METRES UNLESS SHOWN OTHERWISE.
- DO NOT SCALE FROM THIS DRAWING. USE ONLY PRINTED DIMENSIONS.
- PROPOSED EARTHWORK EMBANKMENTS / CUTTINGS HAVE BEEN OMITTED FOR CLARITY.
- THE DESIGN SHOWN WILL BE SUBJECT TO DETAILED DESIGN DEVELOPMENT IN ACCORDANCE WITH THE PROVISIONS OF THE DEVELOPMENT CONSENT ORDER.

- KEY TO SYMBOLS
- DEVELOPMENT CONSENT ORDER BOUNDARY
 - LAND NOT INCLUDED IN ORDER LIMITS
 - PROPOSED ROAD MARKINGS
 - EXISTING HIGHWAY TO BE STOPPED UP
 - EXISTING PRIVATE MEANS OF ACCESS TO BE STOPPED UP
 - NEW, ALTERED OR IMPROVED HIGHWAY - SPECIAL ROAD
 - NEW, ALTERED OR IMPROVED HIGHWAY - TRUNK ROAD
 - NEW, ALTERED OR IMPROVED HIGHWAY - CLASSIFIED ROAD
 - NEW, ALTERED OR IMPROVED PRIVATE MEANS OF ACCESS
 - EXISTING PUBLIC RIGHT OF WAY
 - EXISTING FOOTWAY / FOOTPATH
 - EXISTING CYCLEWAY
 - x x x EXISTING PUBLIC RIGHT OF WAY TO BE PERMANENTLY STOPPED UP
 - x x x EXISTING FOOTWAY / FOOTPATH TO BE PERMANENTLY STOPPED UP
 - x x x EXISTING CYCLEWAY TO BE PERMANENTLY STOPPED UP
 - NEW, ALTERED OR IMPROVED FOOTPATH / CYCLE PATH ROUTE
 - NEW, ALTERED OR IMPROVED FOOTPATH LINK TO EXISTING PUBLIC RIGHT OF WAY
 - NEW, ALTERED OR IMPROVED PUBLIC RIGHT OF WAY
 - PROPOSED STRUCTURE
 - START / END POINT AS DETAILED IN SCHEDULE 3 AND 4 OF THE DEVELOPMENT CONSENT ORDER
 - F/C 1 FOOTWAY / CYCLEWAY REFERENCE AS DETAILED IN SCHEDULE 4 OF THE DEVELOPMENT CONSENT ORDER
 - A PRIVATE MEANS OF ACCESS REFERENCE AS DETAILED IN SCHEDULE 3 AND 4 OF THE DEVELOPMENT CONSENT ORDER
 - PROPOSED SURFACE WATER ATTENUATION BASIN MAINTENANCE ACCESS / TRACK
 - PROPOSED REALIGNED ROUTE OF NCN 23

INSET 1 - EXISTING BUSINESS PARK ACCESS AND EGRESS TO BE STOPPED UP

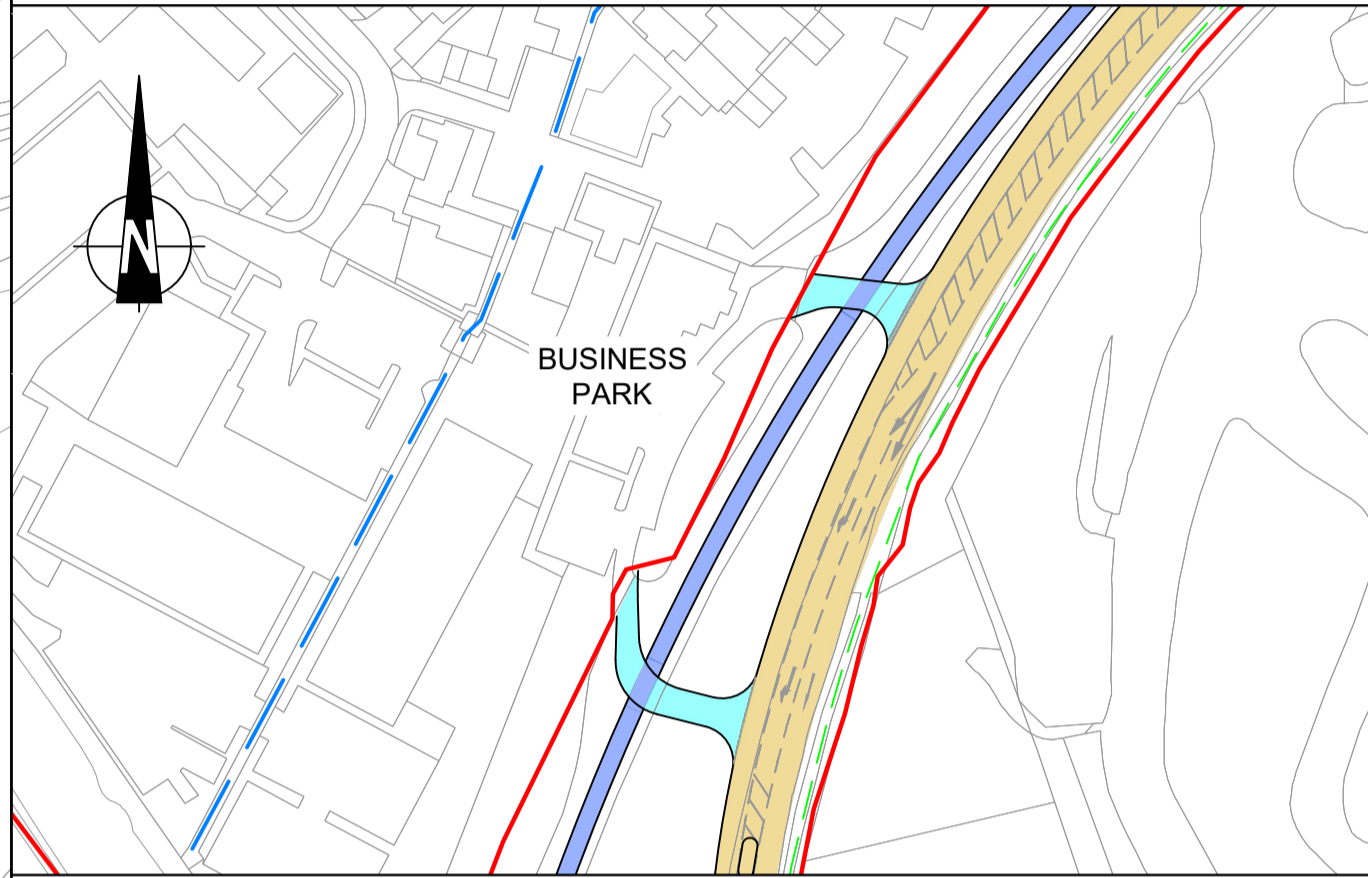

INSET 2 - PROPOSED NEW, ALTERED OR IMPROVED PRIVATE MEANS OF ACCESS

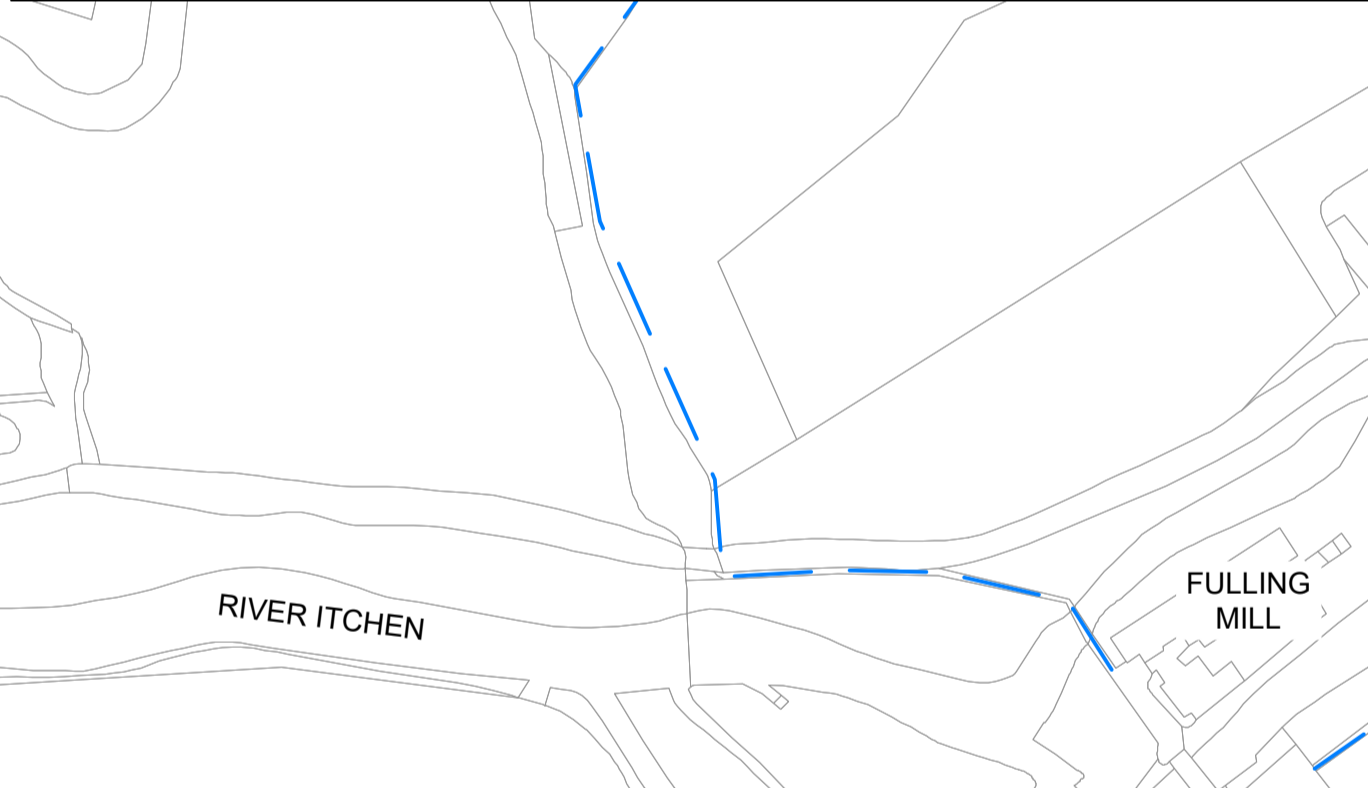

REV	DATE	REVISION NOTE	ORIG	CHKD	APPD
01	JUNE 2023	DEADLINE 2	EO	LC	MF
0	NOVEMBER 2022	APPLICATION SUBMISSION	GP	LC	MF

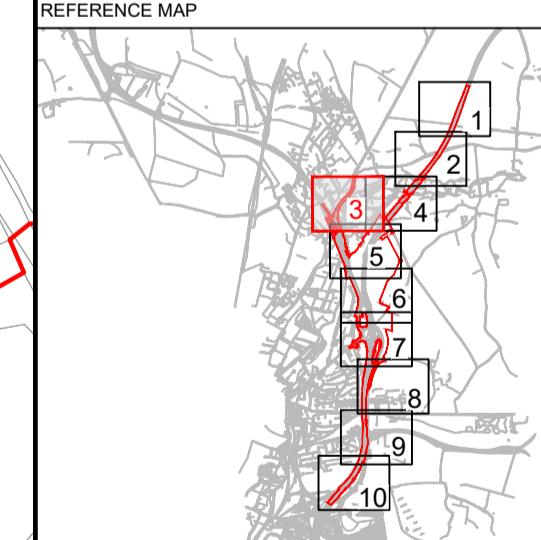

DESIGNER

CONTRACTOR

CLIENT

PROJECT TITLE
 M3 JUNCTION 9 IMPROVEMENT SCHEME

PROJECT STAGE
 PCF STAGE 3

DRAWING TITLE
 RIGHTS OF WAY & ACCESS PLANS
 APFP REGULATION 5(2)(K)
 SHEET 3 OF 10
 DOCUMENT REFERENCE: 2.4

SUITABILITY
 APPLICATION SUBMISSION

SHEET SIZE: A1 SCALE: 1:1250 STATUS: REV 01

DRAWING NUMBER
 HES51511-VFK-LSI-X_XXXX_XX-DR-ZL-2003

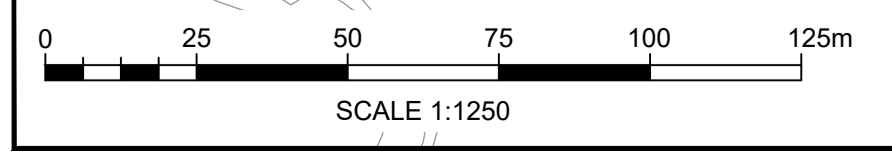

© Crown copyright and database rights 2022. Use of this data is subject to terms and conditions. Ordnance Survey Licence: 100030649

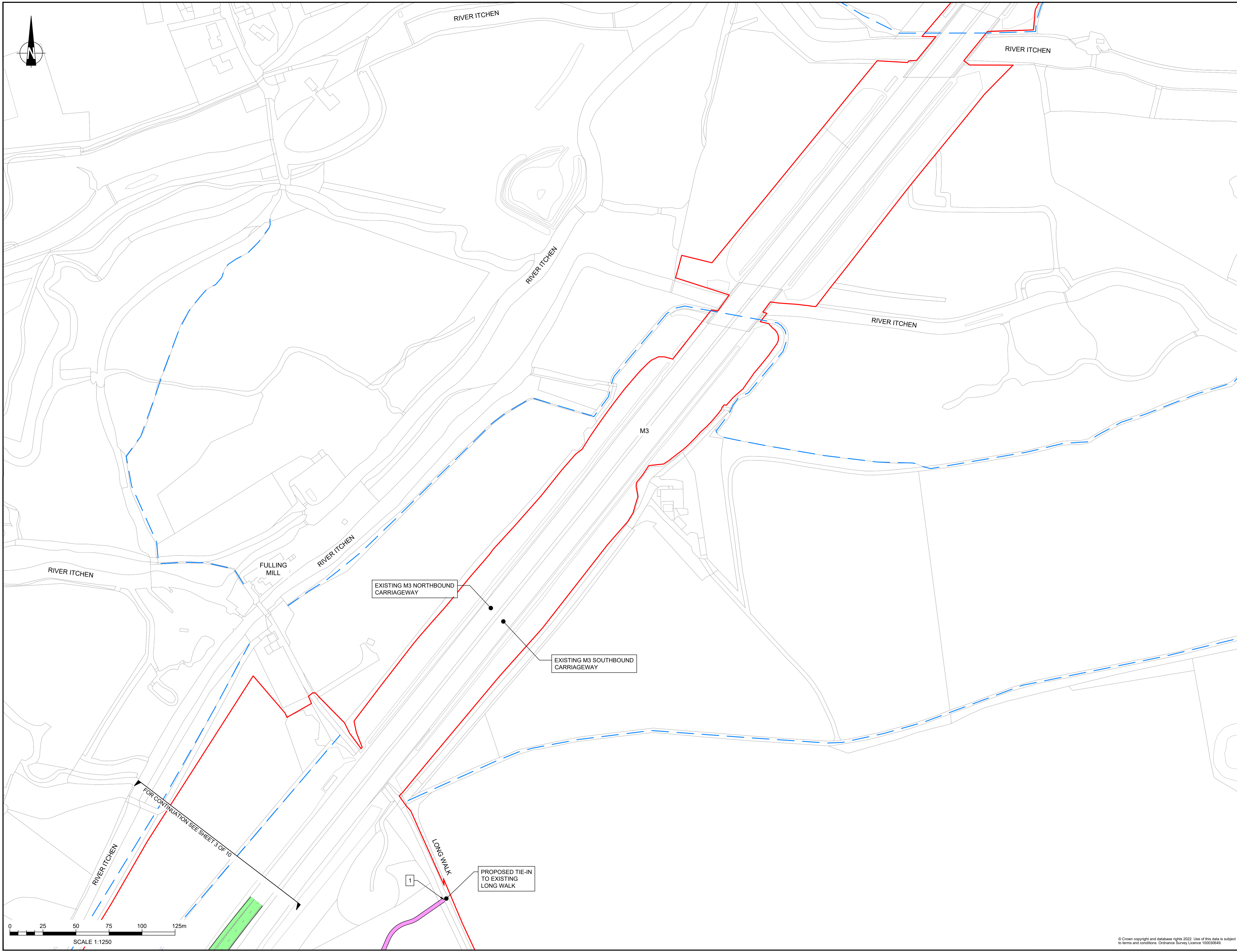

NOTES

Purpose of use
APPLICATION SUBMISSION

Development Consent Order Number / Document
TR010055/2.4

- THIS DRAWING HAS BEEN PRODUCED USING CAD SOFTWARE. THEREFORE ALL DIMENSIONS ARE SHOWN IN METRES UNLESS SHOWN OTHERWISE.
- DO NOT SCALE FROM THIS DRAWING. USE ONLY PRINTED DIMENSIONS.
- PROPOSED EARTHWORK EMBANKMENTS / CUTTINGS HAVE BEEN OMITTED FOR CLARITY.
- THE DESIGN SHOWN WILL BE SUBJECT TO DETAILED DESIGN DEVELOPMENT IN ACCORDANCE WITH THE PROVISIONS OF THE DEVELOPMENT CONSENT ORDER.

KEY TO SYMBOLS

- DEVELOPMENT CONSENT ORDER BOUNDARY
- LAND NOT INCLUDED IN ORDER LIMITS
- PROPOSED ROAD MARKINGS
- EXISTING HIGHWAY TO BE STOPPED UP
- EXISTING PRIVATE MEANS OF ACCESS TO BE STOPPED UP
- NEW, ALTERED OR IMPROVED HIGHWAY - SPECIAL ROAD
- NEW, ALTERED OR IMPROVED HIGHWAY - TRUNK ROAD
- NEW, ALTERED OR IMPROVED HIGHWAY - CLASSIFIED ROAD
- NEW, ALTERED OR IMPROVED PRIVATE MEANS OF ACCESS
- - - EXISTING PUBLIC RIGHT OF WAY
- - - EXISTING FOOTWAY / FOOTPATH
- - - EXISTING CYCLEWAY
- x x x EXISTING PUBLIC RIGHT OF WAY TO BE PERMANENTLY STOPPED UP
- x x x EXISTING FOOTWAY / FOOTPATH TO BE PERMANENTLY STOPPED UP
- x x x EXISTING CYCLEWAY TO BE PERMANENTLY STOPPED UP
- NEW, ALTERED OR IMPROVED FOOTPATH / CYCLE PATH ROUTE
- NEW, ALTERED OR IMPROVED FOOTPATH LINK TO EXISTING PUBLIC RIGHT OF WAY
- NEW, ALTERED OR IMPROVED PUBLIC RIGHT OF WAY
- PROPOSED STRUCTURE
- START / END POINT AS DETAILED IN SCHEDULE 3 AND 4 OF THE DEVELOPMENT CONSENT ORDER
- F/C 1 FOOTWAY / CYCLEWAY REFERENCE AS DETAILED IN SCHEDULE 4 OF THE DEVELOPMENT CONSENT ORDER
- A PRIVATE MEANS OF ACCESS REFERENCE AS DETAILED IN SCHEDULE 3 AND 4 OF THE DEVELOPMENT CONSENT ORDER
- PROPOSED SURFACE WATER ATTENUATION BASIN MAINTENANCE ACCESS / TRACK
- PROPOSED REALIGNED ROUTE OF NCN 23

01	JUNE 2023	DEADLINE 2	EO	LC	MF
0	NOVEMBER 2022	APPLICATION SUBMISSION	GP	LC	MF
REV	DATE	REVISION NOTE	ORIG	CHKD	APPD

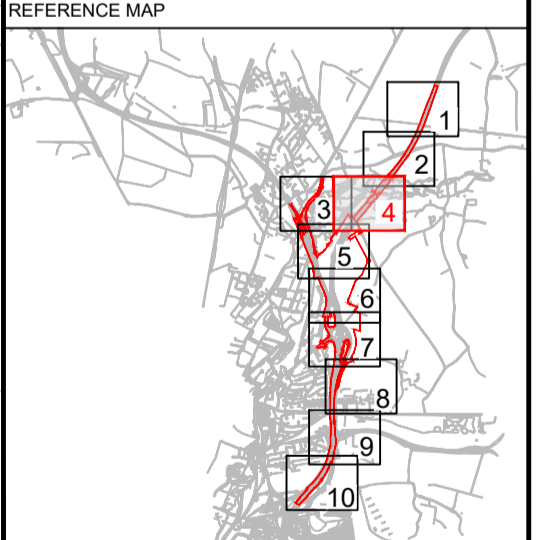

DESIGNER

CONTRACTOR

CLIENT

PROJECT TITLE
M3 JUNCTION 9 IMPROVEMENT SCHEME

PROJECT STAGE
PCF STAGE 3

DRAWING TITLE
**RIGHTS OF WAY & ACCESS PLANS
 APPP REGULATION 5(2)(k)
 SHEET 4 OF 10
 DOCUMENT REFERENCE: 2.4**

SUITABILITY
APPLICATION SUBMISSION

SHEET SIZE: A1 SCALE: 1:1250 STATUS: REV 01
 DRAWING NUMBER
 HES51511-VFK-LSI-X_XXXX_XX-DR-ZL-2004

© Crown copyright and database rights 2022. Use of this data is subject to terms and conditions. Ordnance Survey Licence 100030649.

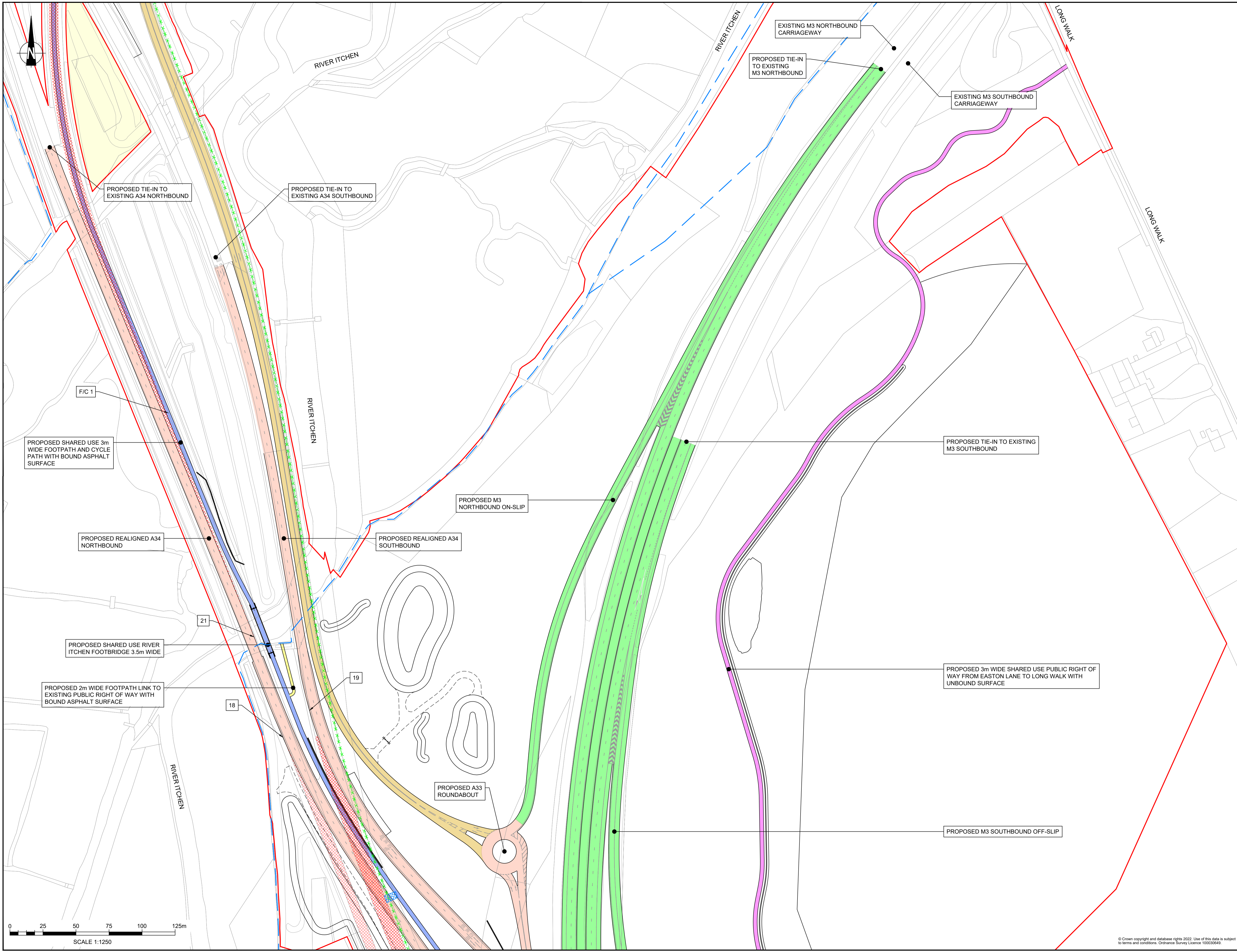

NOTES

Purpose of use
APPLICATION SUBMISSION

Development Consent Order Number / Document
 TR010055/2.4

- THIS DRAWING HAS BEEN PRODUCED USING CAD SOFTWARE. THEREFORE ALL DIMENSIONS ARE SHOWN IN METRES UNLESS SHOWN OTHERWISE.
- DO NOT SCALE FROM THIS DRAWING. USE ONLY PRINTED DIMENSIONS.
- PROPOSED EARTHWORK EMBANKMENTS / CUTTINGS HAVE BEEN OMITTED FOR CLARITY.
- THE DESIGN SHOWN WILL BE SUBJECT TO DETAILED DESIGN DEVELOPMENT IN ACCORDANCE WITH THE PROVISIONS OF THE DEVELOPMENT CONSENT ORDER.

- KEY TO SYMBOLS
- DEVELOPMENT CONSENT ORDER BOUNDARY
 - LAND NOT INCLUDED IN ORDER LIMITS
 - PROPOSED ROAD MARKINGS
 - EXISTING HIGHWAY TO BE STOPPED UP
 - EXISTING PRIVATE MEANS OF ACCESS TO BE STOPPED UP
 - NEW, ALTERED OR IMPROVED HIGHWAY - SPECIAL ROAD
 - NEW, ALTERED OR IMPROVED HIGHWAY - TRUNK ROAD
 - NEW, ALTERED OR IMPROVED HIGHWAY - CLASSIFIED ROAD
 - NEW, ALTERED OR IMPROVED PRIVATE MEANS OF ACCESS
 - EXISTING PUBLIC RIGHT OF WAY
 - EXISTING FOOTWAY / FOOTPATH
 - EXISTING CYCLEWAY
 - x x x EXISTING PUBLIC RIGHT OF WAY TO BE PERMANENTLY STOPPED UP
 - x x x EXISTING FOOTWAY / FOOTPATH TO BE PERMANENTLY STOPPED UP
 - x x x EXISTING CYCLEWAY TO BE PERMANENTLY STOPPED UP
 - NEW, ALTERED OR IMPROVED FOOTPATH / CYCLE PATH ROUTE
 - NEW, ALTERED OR IMPROVED FOOTPATH LINK TO EXISTING PUBLIC RIGHT OF WAY
 - NEW, ALTERED OR IMPROVED PUBLIC RIGHT OF WAY
 - PROPOSED STRUCTURE
 - 1 START / END POINT AS DETAILED IN SCHEDULE 3 AND 4 OF THE DEVELOPMENT CONSENT ORDER
 - F/C 1 FOOTWAY / CYCLEWAY REFERENCE AS DETAILED IN SCHEDULE 4 OF THE DEVELOPMENT CONSENT ORDER
 - A PRIVATE MEANS OF ACCESS REFERENCE AS DETAILED IN SCHEDULE 3 AND 4 OF THE DEVELOPMENT CONSENT ORDER
 - PROPOSED SURFACE WATER ATTENUATION BASIN MAINTENANCE ACCESS / TRACK
 - PROPOSED REALIGNED ROUTE OF NCN 23

01	JUNE 2023	DEADLINE 2	EO	LC	MF
0	NOVEMBER 2022	APPLICATION SUBMISSION	GP	LC	MF
REV	DATE	REVISION NOTE	ORIG	CHKD	APPD

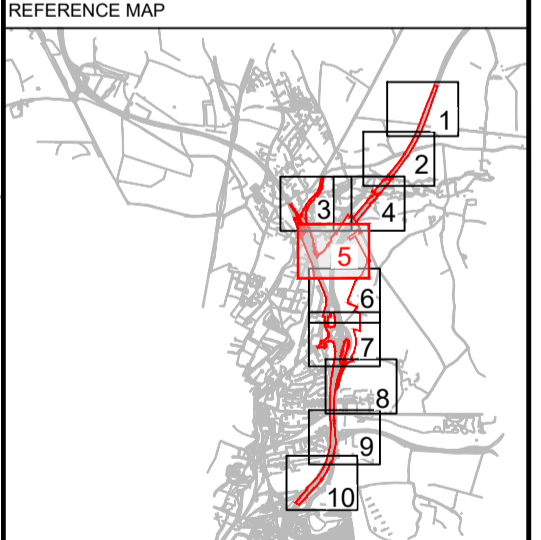

DESIGNER

CONTRACTOR

CLIENT

PROJECT TITLE
M3 JUNCTION 9 IMPROVEMENT SCHEME

PROJECT STAGE
 PCF STAGE 3

DRAWING TITLE
 RIGHTS OF WAY & ACCESS PLANS
 APFP REGULATION S(2)(K)
 SHEET 5 OF 10
 DOCUMENT REFERENCE: 2.4

SUITABILITY
 APPLICATION SUBMISSION

SHEET SIZE: A1 SCALE: 1:1250 STATUS: REV 01

DRAWING NUMBER
 HES51511-VFK-LSI-X_XXXX_XX-DR-ZL-2005

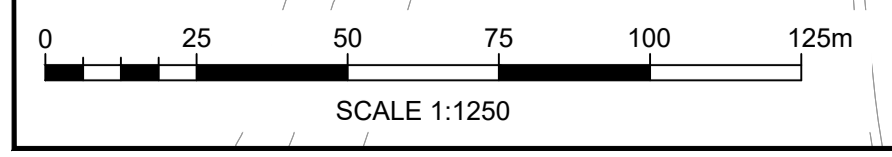

© Crown copyright and database rights 2022. Use of this data is subject to terms and conditions. Ordnance Survey Licence 100030649.

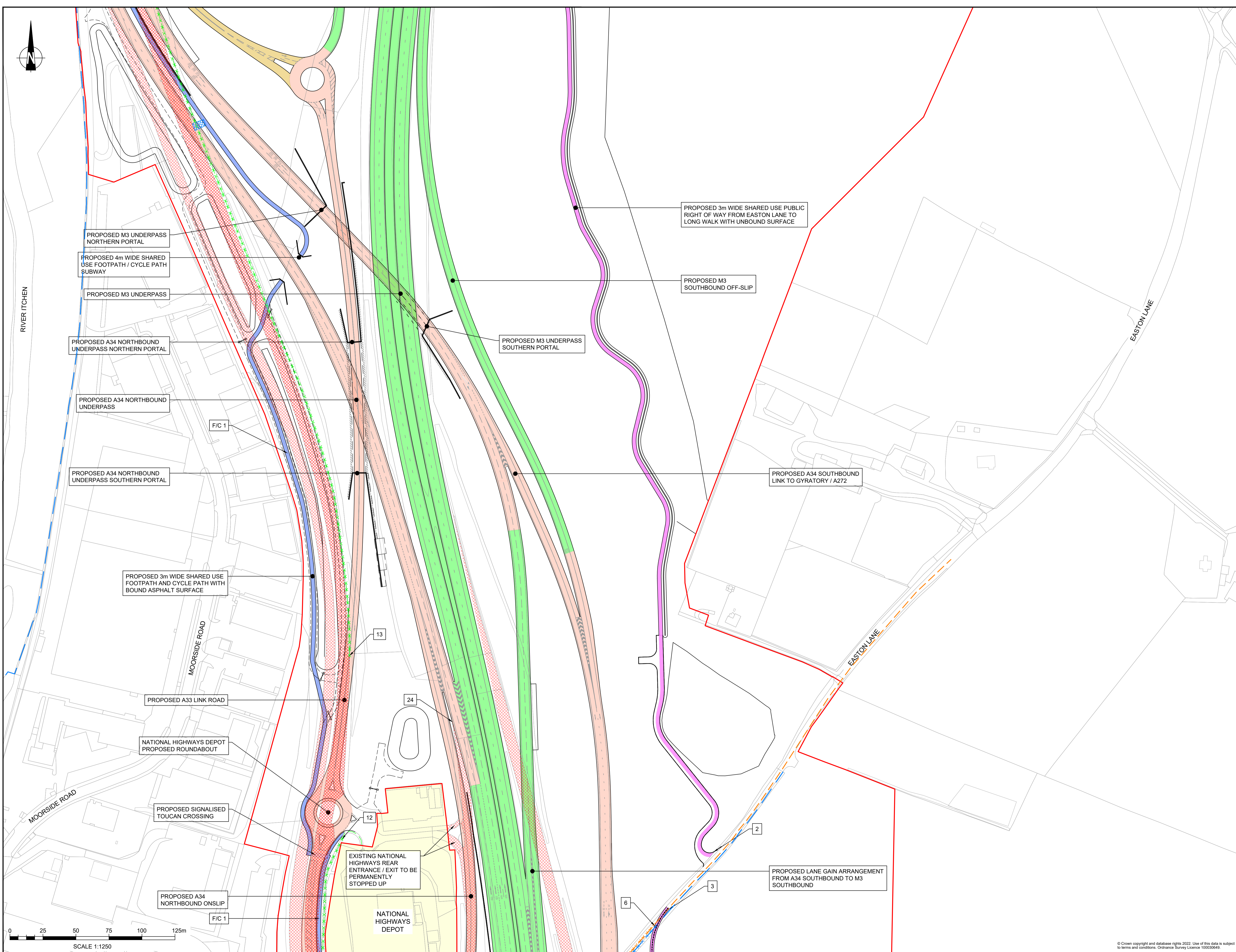

NOTES

Purpose of use
APPLICATION SUBMISSION
 Development Consent Order Number / Document
 TR010055/2.4

- THIS DRAWING HAS BEEN PRODUCED USING CAD SOFTWARE. THEREFORE ALL DIMENSIONS ARE SHOWN IN METRES UNLESS SHOWN OTHERWISE.
- DO NOT SCALE FROM THIS DRAWING. USE ONLY PRINTED DIMENSIONS.
- PROPOSED EARTHWORK EMBANKMENTS / CUTTINGS HAVE BEEN OMITTED FOR CLARITY.
- THE DESIGN SHOWN WILL BE SUBJECT TO DETAILED DESIGN DEVELOPMENT IN ACCORDANCE WITH THE PROVISIONS OF THE DEVELOPMENT CONSENT ORDER.

KEY TO SYMBOLS

- DEVELOPMENT CONSENT ORDER BOUNDARY
- LAND NOT INCLUDED IN ORDER LIMITS
- PROPOSED ROAD MARKINGS
- EXISTING HIGHWAY TO BE STOPPED UP
- EXISTING PRIVATE MEANS OF ACCESS TO BE STOPPED UP
- NEW, ALTERED OR IMPROVED HIGHWAY - SPECIAL ROAD
- NEW, ALTERED OR IMPROVED HIGHWAY - CLASSIFIED ROAD
- NEW, ALTERED OR IMPROVED PRIVATE MEANS OF ACCESS
- EXISTING PUBLIC RIGHT OF WAY
- EXISTING FOOTWAY / FOOTPATH
- EXISTING CYCLEWAY
- EXISTING PUBLIC RIGHT OF WAY TO BE PERMANENTLY STOPPED UP
- EXISTING FOOTWAY / FOOTPATH TO BE PERMANENTLY STOPPED UP
- EXISTING CYCLEWAY TO BE PERMANENTLY STOPPED UP
- NEW, ALTERED OR IMPROVED FOOTPATH / CYCLE PATH ROUTE
- NEW, ALTERED OR IMPROVED FOOTPATH LINK TO EXISTING PUBLIC RIGHT OF WAY
- NEW, ALTERED OR IMPROVED PUBLIC RIGHT OF WAY
- PROPOSED STRUCTURE
- START / END POINT AS DETAILED IN SCHEDULE 3 AND 4 OF THE DEVELOPMENT CONSENT ORDER
- FOOTWAY / CYCLEWAY REFERENCE AS DETAILED IN SCHEDULE 4 OF THE DEVELOPMENT CONSENT ORDER
- PRIVATE MEANS OF ACCESS REFERENCE AS DETAILED IN SCHEDULE 3 AND 4 OF THE DEVELOPMENT CONSENT ORDER
- PROPOSED SURFACE WATER ATTENUATION BASIN MAINTENANCE ACCESS / TRACK
- PROPOSED REALIGNED ROUTE OF NCN 23

01	JUNE 2023	DEADLINE 2	EO	LC	MF
0	NOVEMBER 2022	APPLICATION SUBMISSION	GP	LC	MF
REV	DATE	REVISION NOTE	ORIG	CHKD	APPD

REFERENCE MAP

DESIGNER
Stantec

CONTRACTOR
VolkerFitzpatrick

CLIENT
national highways

PROJECT TITLE
M3 JUNCTION 9 IMPROVEMENT SCHEME

PROJECT STAGE
 PCF STAGE 3

DRAWING TITLE
**RIGHTS OF WAY & ACCESS PLANS
 APFP REGULATION 5(2)(K)
 SHEET 6 OF 10
 DOCUMENT REFERENCE: 2.4**

SUITABILITY
APPLICATION SUBMISSION

SHEET SIZE: A1 SCALE: 1:1250 STATUS: REV 01
 DRAWING NUMBER
 HES51511-VFK-LSI-X_XXXX_XX-DR-ZL-2006

© Crown copyright and database rights 2022. Use of this data is subject to terms and conditions. Ordnance Survey Licence 100030649.

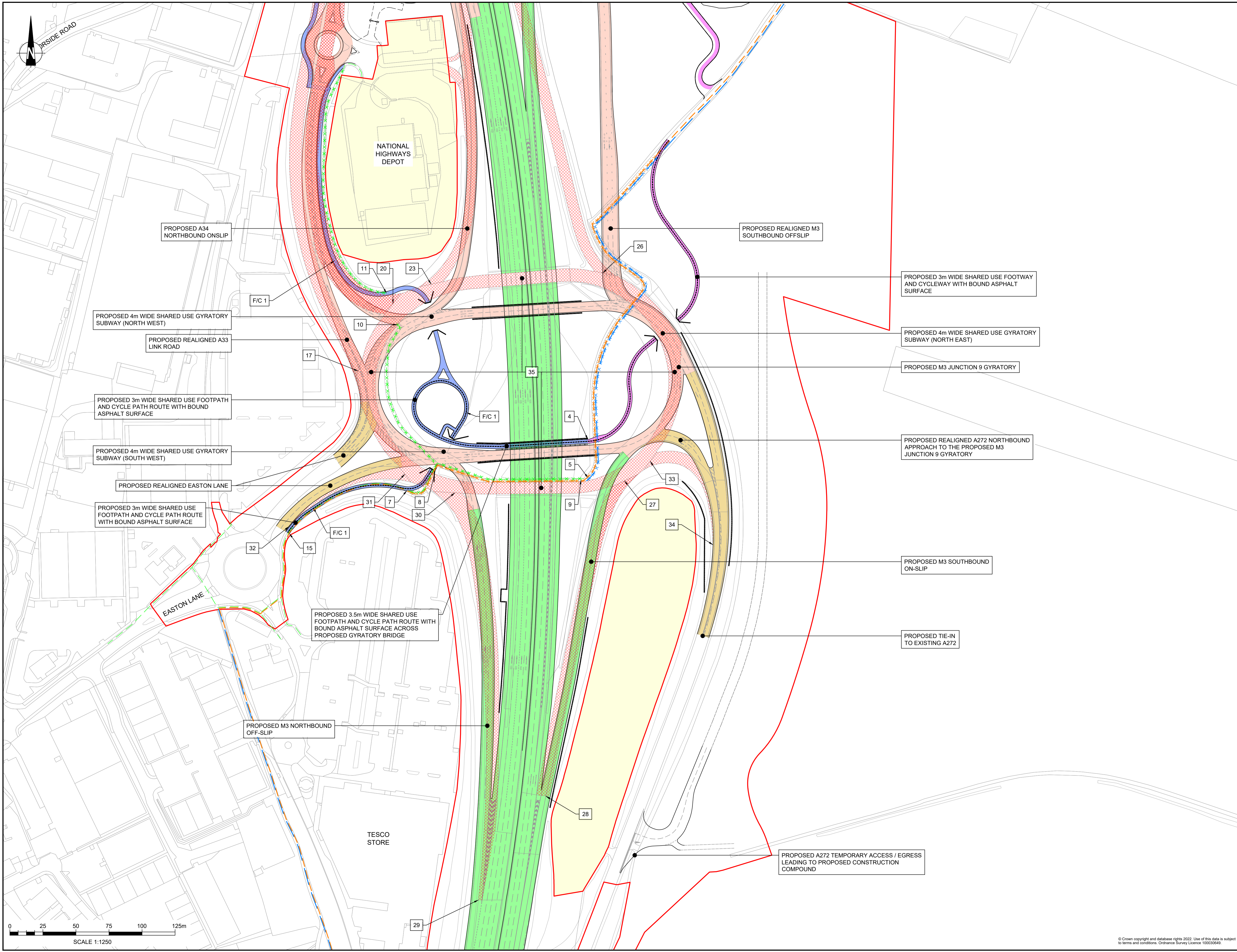

NOTES

Purpose of use
APPLICATION SUBMISSION
 Development Consent Order Number / Document
 TR010055/2.4

- THIS DRAWING HAS BEEN PRODUCED USING CAD SOFTWARE. THEREFORE ALL DIMENSIONS ARE SHOWN IN METRES UNLESS SHOWN OTHERWISE.
- DO NOT SCALE FROM THIS DRAWING. USE ONLY PRINTED DIMENSIONS.
- PROPOSED EARTHWORK EMBANKMENTS / CUTTINGS HAVE BEEN OMITTED FOR CLARITY.
- THE DESIGN SHOWN WILL BE SUBJECT TO DETAILED DESIGN DEVELOPMENT IN ACCORDANCE WITH THE PROVISIONS OF THE DEVELOPMENT CONSENT ORDER.

KEY TO SYMBOLS

- DEVELOPMENT CONSENT ORDER BOUNDARY
- LAND NOT INCLUDED IN ORDER LIMITS
- PROPOSED ROAD MARKINGS
- EXISTING HIGHWAY TO BE STOPPED UP
- EXISTING PRIVATE MEANS OF ACCESS TO BE STOPPED UP
- NEW, ALTERED OR IMPROVED HIGHWAY - SPECIAL ROAD
- NEW, ALTERED OR IMPROVED HIGHWAY - TRUNK ROAD
- NEW, ALTERED OR IMPROVED HIGHWAY - CLASSIFIED ROAD
- NEW, ALTERED OR IMPROVED PRIVATE MEANS OF ACCESS
- EXISTING PUBLIC RIGHT OF WAY
- EXISTING FOOTWAY / FOOTPATH
- EXISTING CYCLEWAY
- EXISTING PUBLIC RIGHT OF WAY TO BE PERMANENTLY STOPPED UP
- EXISTING FOOTWAY / FOOTPATH TO BE PERMANENTLY STOPPED UP
- EXISTING CYCLEWAY TO BE PERMANENTLY STOPPED UP
- NEW, ALTERED OR IMPROVED FOOTPATH / CYCLE PATH ROUTE
- NEW, ALTERED OR IMPROVED FOOTPATH LINK TO EXISTING PUBLIC RIGHT OF WAY
- NEW, ALTERED OR IMPROVED PUBLIC RIGHT OF WAY
- PROPOSED STRUCTURE
- START / END POINT AS DETAILED IN SCHEDULE 3 AND 4 OF THE DEVELOPMENT CONSENT ORDER
- FOOTWAY / CYCLEWAY REFERENCE AS DETAILED IN SCHEDULE 4 OF THE DEVELOPMENT CONSENT ORDER
- PRIVATE MEANS OF ACCESS REFERENCE AS DETAILED IN SCHEDULE 3 AND 4 OF THE DEVELOPMENT CONSENT ORDER
- PROPOSED SURFACE WATER ATTENUATION BASIN MAINTENANCE ACCESS / TRACK
- PROPOSED REALIGNED ROUTE OF NCN 23

REV	DATE	REVISION NOTE	ORIG	CHKD	APPD
01	JUNE 2023	DEADLINE 2	EO	LC	MF
0	NOVEMBER 2022	APPLICATION SUBMISSION	GP	LC	MF

REFERENCE MAP

DESIGNER
Stantec

CONTRACTOR
VolkerFitzpatrick

CLIENT
national highways

PROJECT TITLE
M3 JUNCTION 9 IMPROVEMENT SCHEME

PROJECT STAGE
PCF STAGE 3

DRAWING TITLE
**RIGHTS OF WAY & ACCESS PLANS
 APPP REGULATION S(2)(K)
 SHEET 7 OF 10
 DOCUMENT REFERENCE: 2.4**

SUITABILITY
APPLICATION SUBMISSION

SHEET SIZE: A1 SCALE: 1:1250 STATUS: REV 01

DRAWING NUMBER
 HES51511-VFK-LSI-X_XXXX_XX-DR-ZL-2007

© Crown copyright and database rights 2022. Use of this data is subject to terms and conditions. Ordnance Survey Licence 100030649

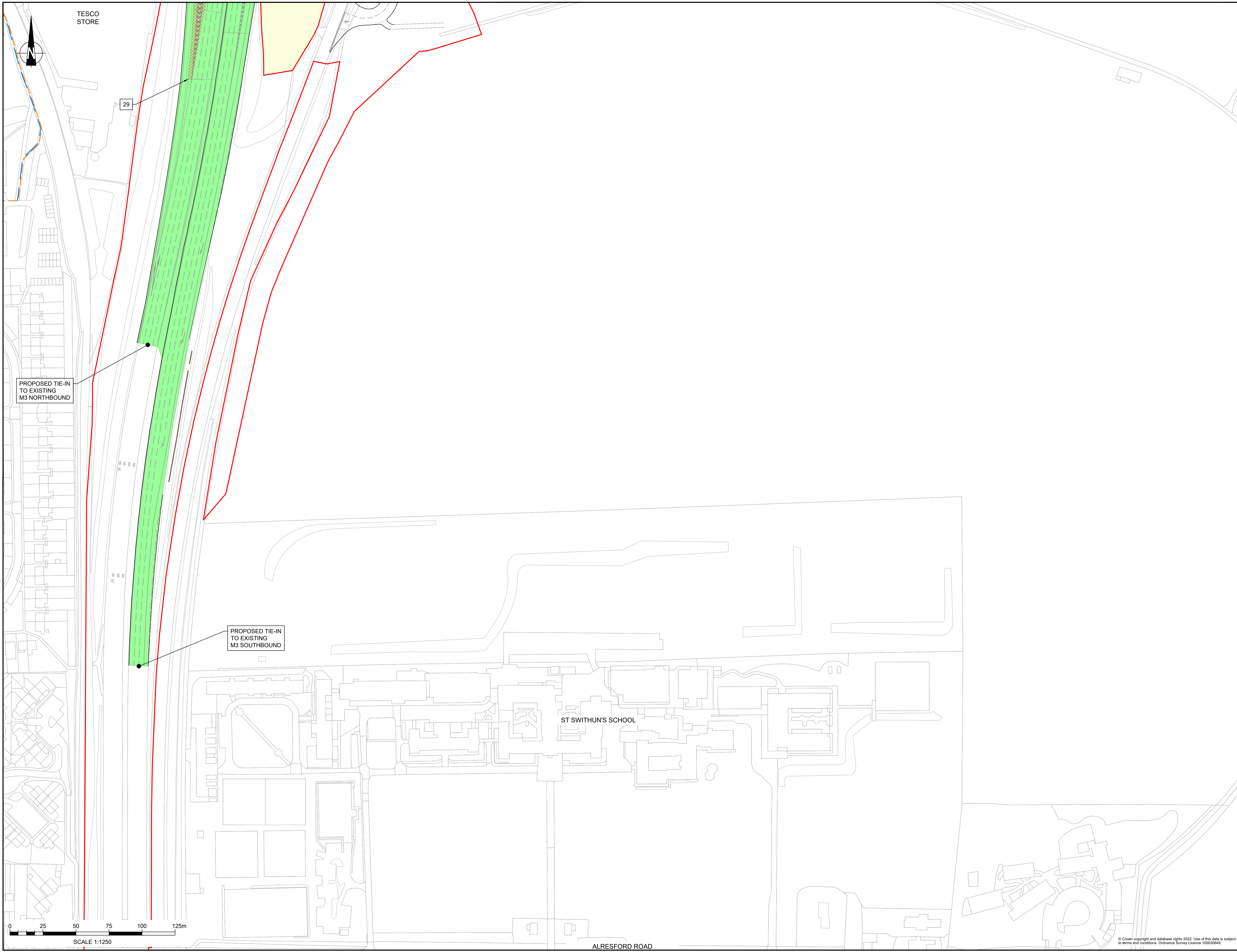

TESCO STORE

29

PROPOSED TIE-IN TO EXISTING M3 NORTHBOUND

PROPOSED TIE-IN TO EXISTING M3 SOUTHBOUND

ST SWITHUN'S SCHOOL

ALRESFORD ROAD

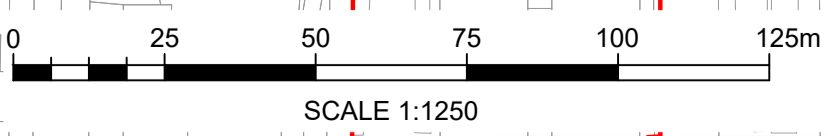

NOTES

Purpose of use
APPLICATION SUBMISSION
 Development Consent Order Number / Document
TR010055/2.4

- THIS DRAWING HAS BEEN PRODUCED USING CAD SOFTWARE. THEREFORE ALL DIMENSIONS ARE SHOWN IN METRES UNLESS SHOWN OTHERWISE.
- DO NOT SCALE FROM THIS DRAWING. USE ONLY PRINTED DIMENSIONS.
- PROPOSED EARTHWORK EMBANKMENTS / CUTTINGS HAVE BEEN OMITTED FOR CLARITY.
- THE DESIGN SHOWN WILL BE SUBJECT TO DETAILED DESIGN DEVELOPMENT IN ACCORDANCE WITH THE PROVISIONS OF THE DEVELOPMENT CONSENT ORDER.

KEY TO SYMBOLS

- DEVELOPMENT CONSENT ORDER BOUNDARY
- LAND NOT INCLUDED IN ORDER LIMITS
- PROPOSED ROAD MARKINGS
- EXISTING HIGHWAY TO BE STOPPED UP
- EXISTING PRIVATE MEANS OF ACCESS TO BE STOPPED UP
- NEW, ALTERED OR IMPROVED HIGHWAY - SPECIAL ROAD
- NEW, ALTERED OR IMPROVED HIGHWAY - TRUNK ROAD
- NEW, ALTERED OR IMPROVED HIGHWAY - CLASSIFIED ROAD
- NEW, ALTERED OR IMPROVED PRIVATE MEANS OF ACCESS
- EXISTING PUBLIC RIGHT OF WAY
- EXISTING FOOTWAY / FOOTPATH
- EXISTING CYCLEWAY
- EXISTING PUBLIC RIGHT OF WAY TO BE PERMANENTLY STOPPED UP
- EXISTING FOOTWAY / FOOTPATH TO BE PERMANENTLY STOPPED UP
- EXISTING CYCLEWAY TO BE PERMANENTLY STOPPED UP
- NEW, ALTERED OR IMPROVED FOOTPATH / CYCLE PATH ROUTE
- NEW, ALTERED OR IMPROVED FOOTPATH LINK TO EXISTING PUBLIC RIGHT OF WAY
- NEW, ALTERED OR IMPROVED PUBLIC RIGHT OF WAY
- PROPOSED STRUCTURE
- START / END POINT AS DETAILED IN SCHEDULE 3 AND 4 OF THE DEVELOPMENT CONSENT ORDER
- FOOTWAY / CYCLEWAY REFERENCE AS DETAILED IN SCHEDULE 4 OF THE DEVELOPMENT CONSENT ORDER
- PRIVATE MEANS OF ACCESS REFERENCE AS DETAILED IN SCHEDULE 3 AND 4 OF THE DEVELOPMENT CONSENT ORDER
- PROPOSED SURFACE WATER ATTENUATION BASIN MAINTENANCE ACCESS / TRACK
- PROPOSED REALIGNED ROUTE OF NCN 23

01	JUNE 2023	DEADLINE 2	EO	LC	MF
0	NOVEMBER 2022	APPLICATION SUBMISSION	GP	LC	MF
REV	DATE	REVISION NOTE	ORIG	CHKD	APPD

REFERENCE MAP

DESIGNER
Stantec

CONTRACTOR
VolkerFitzpatrick

CLIENT
national highways

PROJECT TITLE
M3 JUNCTION 9 IMPROVEMENT SCHEME

PROJECT STAGE
PCF STAGE 3

DRAWING TITLE
**RIGHTS OF WAY & ACCESS PLANS
 APFP REGULATION S(2)(K)
 SHEET 8 OF 10
 DOCUMENT REFERENCE: 2.4**

SUITABILITY
APPLICATION SUBMISSION

SHEET SIZE: A1 SCALE: 1:1250 STATUS: REV 01

DRAWING NUMBER
HE51511-VFK-LSI-X_XXXX_XX-DR-ZL-2008

© Crown copyright and database rights 2022. Use of this data is subject to terms and conditions. Ordnance Survey Licence 100030649.

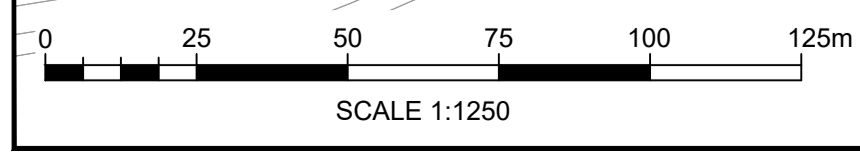
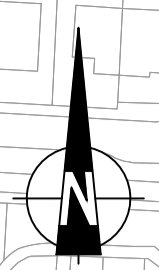
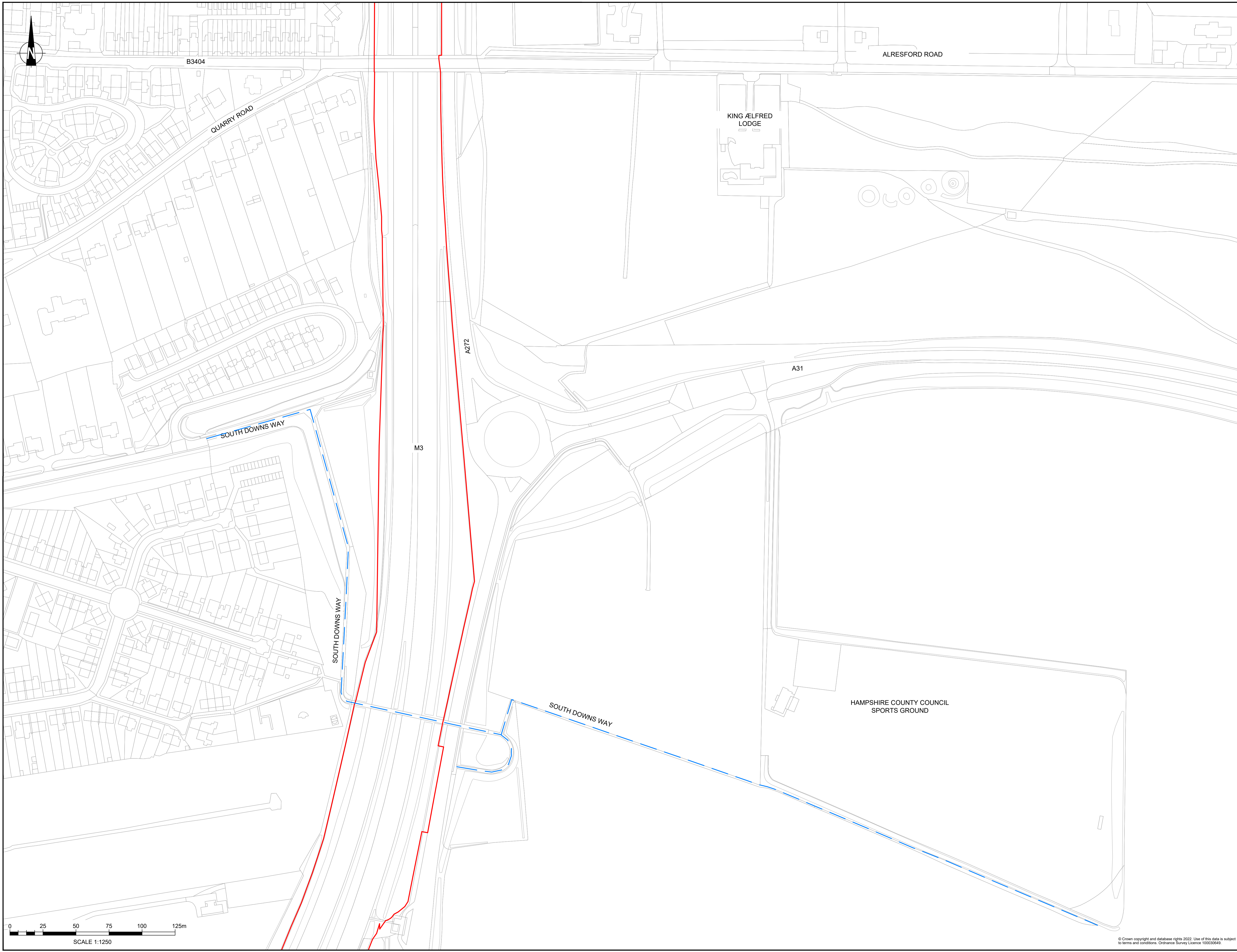

NOTES

Purpose of use
APPLICATION SUBMISSION
 Development Consent Order Number / Document
TR010055/2.4

- THIS DRAWING HAS BEEN PRODUCED USING CAD SOFTWARE. THEREFORE ALL DIMENSIONS ARE SHOWN IN METRES UNLESS SHOWN OTHERWISE.
- DO NOT SCALE FROM THIS DRAWING. USE ONLY PRINTED DIMENSIONS.
- PROPOSED EARTHWORK EMBANKMENTS / CUTTINGS HAVE BEEN OMITTED FOR CLARITY.
- THE DESIGN SHOWN WILL BE SUBJECT TO DETAILED DESIGN DEVELOPMENT IN ACCORDANCE WITH THE PROVISIONS OF THE DEVELOPMENT CONSENT ORDER.

KEY TO SYMBOLS

- DEVELOPMENT CONSENT ORDER BOUNDARY
- LAND NOT INCLUDED IN ORDER LIMITS
- PROPOSED ROAD MARKINGS
- EXISTING HIGHWAY TO BE STOPPED UP
- EXISTING PRIVATE MEANS OF ACCESS TO BE STOPPED UP
- NEW, ALTERED OR IMPROVED HIGHWAY - SPECIAL ROAD
- NEW, ALTERED OR IMPROVED HIGHWAY - TRUNK ROAD
- NEW, ALTERED OR IMPROVED HIGHWAY - CLASSIFIED ROAD
- NEW, ALTERED OR IMPROVED PRIVATE MEANS OF ACCESS
- EXISTING PUBLIC RIGHT OF WAY
- EXISTING FOOTWAY / FOOTPATH
- EXISTING CYCLEWAY
- EXISTING PUBLIC RIGHT OF WAY TO BE PERMANENTLY STOPPED UP
- EXISTING FOOTWAY / FOOTPATH TO BE PERMANENTLY STOPPED UP
- EXISTING CYCLEWAY TO BE PERMANENTLY STOPPED UP
- NEW, ALTERED OR IMPROVED FOOTPATH / CYCLE PATH ROUTE
- NEW, ALTERED OR IMPROVED FOOTPATH LINK TO EXISTING PUBLIC RIGHT OF WAY
- NEW, ALTERED OR IMPROVED PUBLIC RIGHT OF WAY
- PROPOSED STRUCTURE
- START / END POINT AS DETAILED IN SCHEDULE 3 AND 4 OF THE DEVELOPMENT CONSENT ORDER
- FOOTWAY / CYCLEWAY REFERENCE AS DETAILED IN SCHEDULE 4 OF THE DEVELOPMENT CONSENT ORDER
- PRIVATE MEANS OF ACCESS REFERENCE AS DETAILED IN SCHEDULE 3 AND 4 OF THE DEVELOPMENT CONSENT ORDER
- PROPOSED SURFACE WATER ATTENUATION BASIN MAINTENANCE ACCESS / TRACK
- PROPOSED REALIGNED ROUTE OF NCN 23

01	JUNE 2023	DEADLINE 2	EO	LC	MF
0	NOVEMBER 2022	APPLICATION SUBMISSION	GP	LC	MF
REV	DATE	REVISION NOTE	ORIG	CHKD	APPD

REFERENCE MAP

DESIGNER

CONTRACTOR

CLIENT

PROJECT TITLE
M3 JUNCTION 9 IMPROVEMENT SCHEME

PROJECT STAGE
PCF STAGE 3

DRAWING TITLE
**RIGHTS OF WAY & ACCESS PLANS
 APFP REGULATION S(2)(K)
 SHEET 9 OF 10
 DOCUMENT REFERENCE: 2.4**

SUITABILITY
APPLICATION SUBMISSION

SHEET SIZE: A1 | SCALE: 1:1250 | STATUS: REV 01
 DRAWING NUMBER
 HES51511-VFK-LSI-X_XXXX_XX-DR-ZL-2009

© Crown copyright and database rights 2022. Use of this data is subject to terms and conditions. Ordnance Survey Licence 100030649.

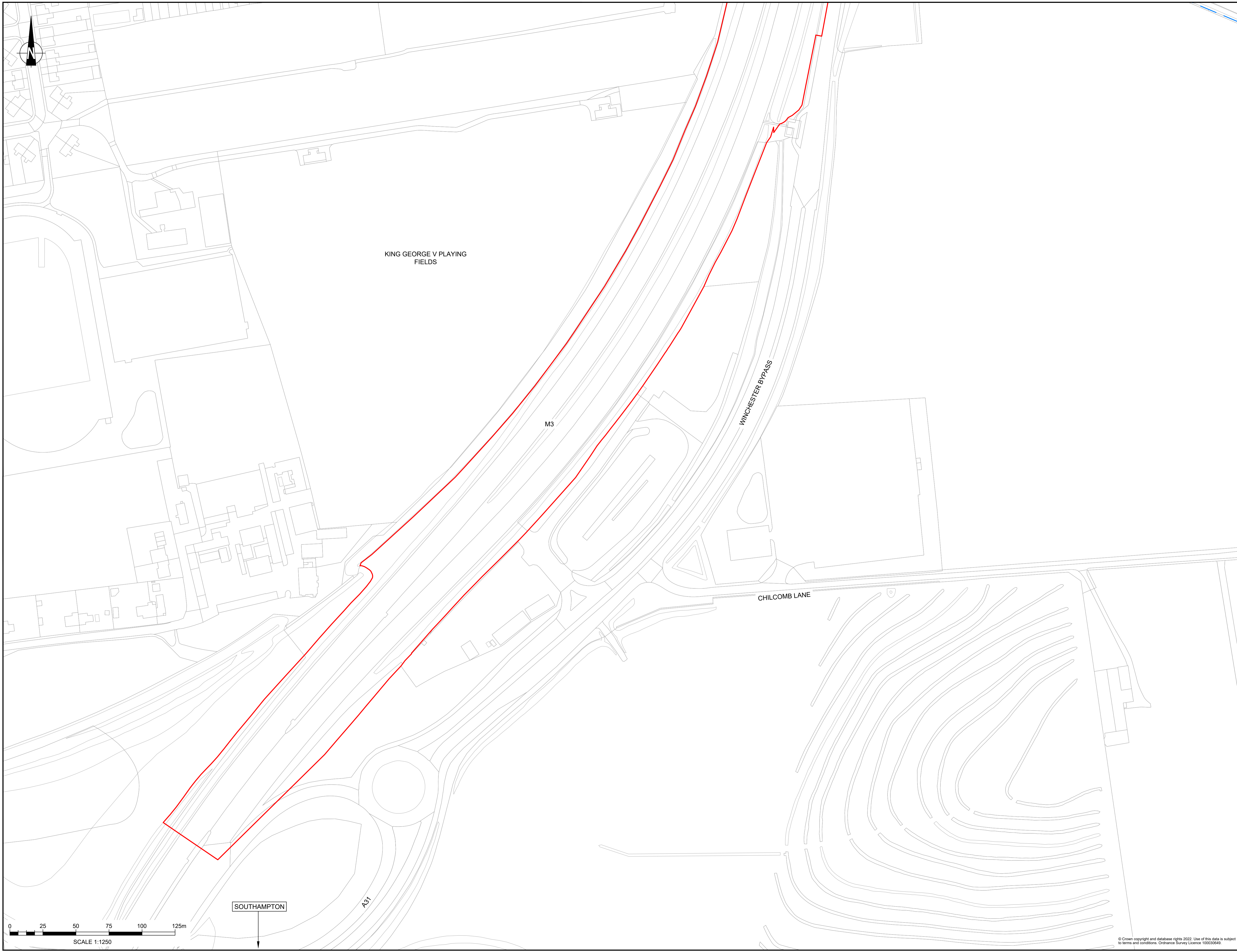

NOTES

Purpose of use
APPLICATION SUBMISSION
 Development Consent Order Number / Document
TR010055/2.4

- THIS DRAWING HAS BEEN PRODUCED USING CAD SOFTWARE. THEREFORE ALL DIMENSIONS ARE SHOWN IN METRES UNLESS SHOWN OTHERWISE.
- DO NOT SCALE FROM THIS DRAWING. USE ONLY PRINTED DIMENSIONS.
- PROPOSED EARTHWORK EMBANKMENTS / CUTTINGS HAVE BEEN OMITTED FOR CLARITY.
- THE DESIGN SHOWN WILL BE SUBJECT TO DETAILED DESIGN DEVELOPMENT IN ACCORDANCE WITH THE PROVISIONS OF THE DEVELOPMENT CONSENT ORDER.

KEY TO SYMBOLS

- DEVELOPMENT CONSENT ORDER BOUNDARY
- LAND NOT INCLUDED IN ORDER LIMITS
- PROPOSED ROAD MARKINGS
- EXISTING HIGHWAY TO BE STOPPED UP
- EXISTING PRIVATE MEANS OF ACCESS TO BE STOPPED UP
- NEW, ALTERED OR IMPROVED HIGHWAY - SPECIAL ROAD
- NEW, ALTERED OR IMPROVED HIGHWAY - TRUNK ROAD
- NEW, ALTERED OR IMPROVED HIGHWAY - CLASSIFIED ROAD
- NEW, ALTERED OR IMPROVED PRIVATE MEANS OF ACCESS
- EXISTING PUBLIC RIGHT OF WAY
- EXISTING FOOTWAY / FOOTPATH
- EXISTING CYCLEWAY
- EXISTING PUBLIC RIGHT OF WAY TO BE PERMANENTLY STOPPED UP
- EXISTING FOOTWAY / FOOTPATH TO BE PERMANENTLY STOPPED UP
- EXISTING CYCLEWAY TO BE PERMANENTLY STOPPED UP
- NEW, ALTERED OR IMPROVED FOOTPATH / CYCLE PATH ROUTE
- NEW, ALTERED OR IMPROVED FOOTPATH LINK TO EXISTING PUBLIC RIGHT OF WAY
- NEW, ALTERED OR IMPROVED PUBLIC RIGHT OF WAY
- PROPOSED STRUCTURE
- START / END POINT AS DETAILED IN SCHEDULE 3 AND 4 OF THE DEVELOPMENT CONSENT ORDER
- FOOTWAY / CYCLEWAY REFERENCE AS DETAILED IN SCHEDULE 4 OF THE DEVELOPMENT CONSENT ORDER
- PRIVATE MEANS OF ACCESS REFERENCE AS DETAILED IN SCHEDULE 3 AND 4 OF THE DEVELOPMENT CONSENT ORDER
- PROPOSED SURFACE WATER ATTENUATION BASIN MAINTENANCE ACCESS / TRACK
- PROPOSED REALIGNED ROUTE OF NCN 23

REV	DATE	REVISION NOTE	ORIG	CHKD	APPD
01	JUNE 2023	DEADLINE 2	EO	LC	MF
0	NOVEMBER 2022	APPLICATION SUBMISSION	GP	LC	MF

REFERENCE MAP

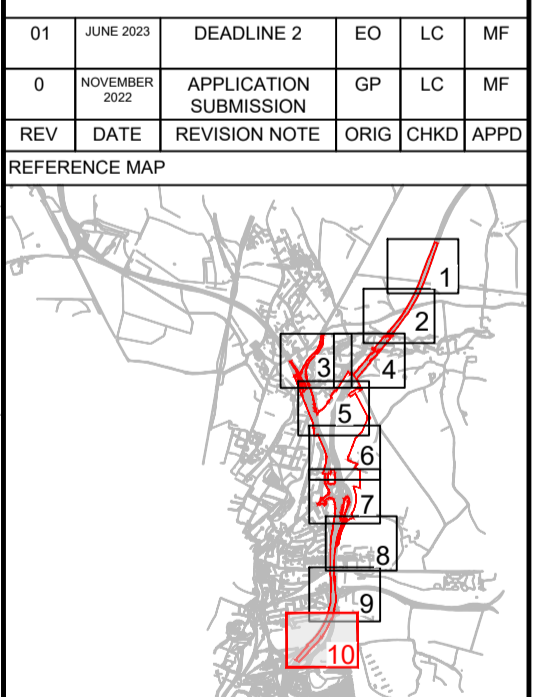

DESIGNER

CONTRACTOR

CLIENT

PROJECT TITLE
M3 JUNCTION 9 IMPROVEMENT SCHEME

PROJECT STAGE
PCF STAGE 3

DRAWING TITLE
**RIGHTS OF WAY & ACCESS PLANS
 APFP REGULATION S(2)(K)
 SHEET 10 OF 10
 DOCUMENT REFERENCE: 2.4**

SUITABILITY
APPLICATION SUBMISSION

SHEET SIZE: A1 | SCALE: 1:1250 | STATUS: REV 01
 DRAWING NUMBER
 HES51511-VFK-LSI-X_XXXX_XX-DR-ZL-2010

© Crown copyright and database rights 2022. Use of this data is subject to terms and conditions. Ordnance Survey Licence: 100030649